

Áreas Tributarias (m2)

Muro	Planta Baja	Planta Alta
1	8.90	6.65
2	8.90	6.65
3	2.25	2.00
4	2.40	2.25
5	4.10	2.10
6	2.00	2.00
7	2.65	2.65
8	2.65	2.65
9	6.75	5.75
10	4.85	3.70
11	6.15	5.90
12	2.40	2.65
13	2.40	2.65
14	3.80	3.27
15	3.80	3.27
16		1.80
17		1.80
18		3.12
19		3.12
TOTAL	64.00	64.00

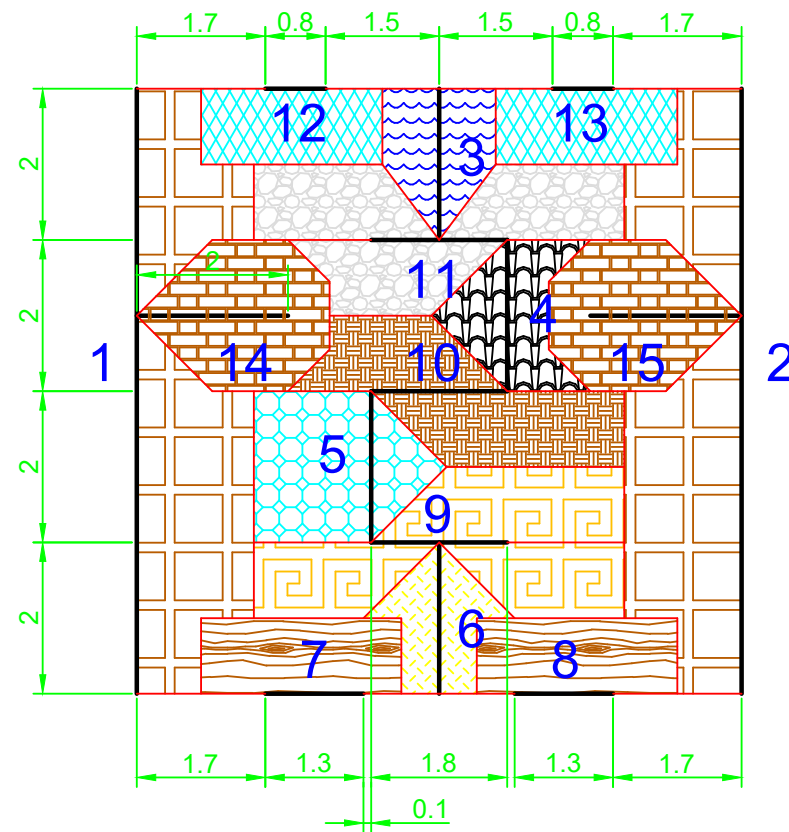

Planta Baja

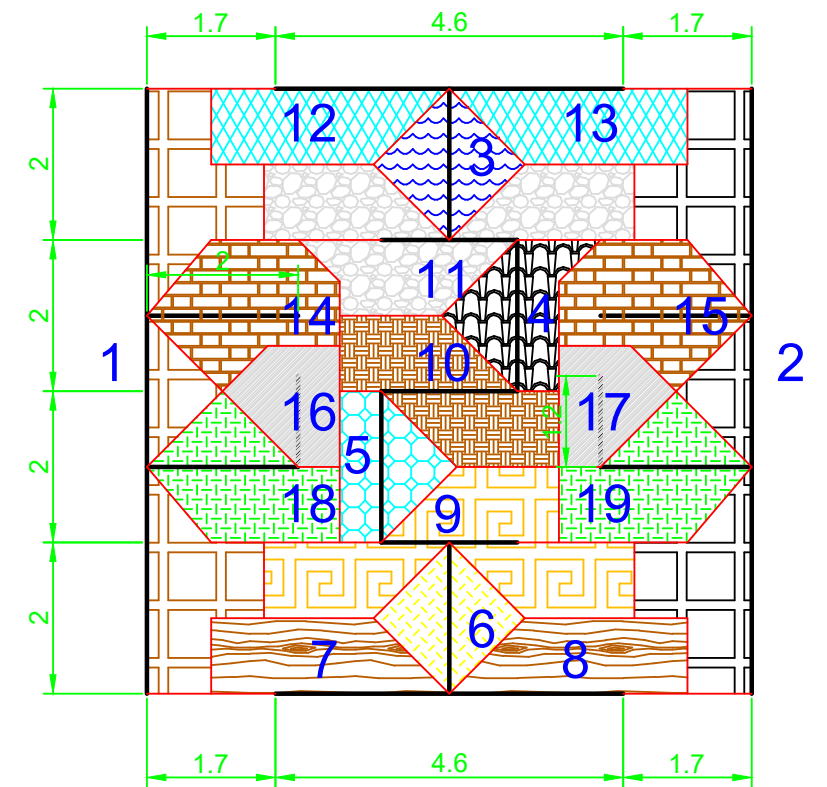

Planta Alta